

FAREHAM

BOROUGH COUNCIL

EXECUTIVE MEMBER DECISION (HEALTH AND PUBLIC PROTECTION)

Date: Tuesday, 22 February 2022

Time: 3.30 pm

Venue: Collingwood Room - Civic Offices

Executive Member: Councillor T M Cartwright, MBE, Deputy Executive Leader



1. Report Published

To consider the following matter(s) for decision for which report(s) have been published:-

Key Decision(s)

- (1) **Fareham Borough Car Parks Traffic Regulation Order - consideration of consultation responses** (Pages 3 - 32)



P GRIMWOOD
Chief Executive Officer

www.fareham.gov.uk

11 February 2022

For further information please contact:
Democratic Services, Civic Offices, Fareham, PO16 7AZ
Tel:01329 236100
democraticservices@fareham.gov.uk

FAREHAM

BOROUGH COUNCIL

Report to the Executive Member for Health and Public Protection for Decision 22 February 2022

Portfolio:	Health and Public Protection
Subject:	Fareham Borough Car Parks Traffic Regulation Order – consideration of consultation responses
Report of:	Director of Leisure and Community
Corporate Priorities:	Strong, Safe, Inclusive and Healthy Communities. Dynamic, Prudent and Progressive Council.

Purpose:

This report sets out the results of the recent Traffic Regulation Order (TRO) consultation for the following car parks: - Portchester Precinct, Holly Hill car park Barnes Lane Sarisbury, Barnes Close car park Sarisbury, Broadcut Retail Park Fareham, Cams Alders car park Fareham, Passage Lane car park Warsash, Burridge Village Hall car park (Main) Botley Road Burridge. The Executive Member for Health and Public Protection is requested to consider the consultation responses and make a decision on the adoption of an updated Off-Street Parking Order.

Executive summary:

There are a number Off-Street Car Parks in the Borough which have not seen their terms of parking amended since 2017. Over the period from then until now a number of issues have arisen and there is a need to amend the terms for a number of the car parks. These issues have been brought to the Council's Notice, by its own Property & Enforcement Teams, members of the public and Elected Members. The affected car parks are Portchester Precinct car park, Holly Hill, Barnes Close, Broadcut Retail Park, Burridge Village Hall Car Park (Main) and Cams Alders Car Park. In addition, a small amendment is required to Passage Lane Car park, following the recent introduction of charging there.

The following amendments to the Traffic Regulation Order were consulted upon between 21st January 2022 and 4th February 2022.

Portchester Precinct

In July 2017, the Executive approved a Regeneration Vision for Portchester Village Centre entitled 'Putting the Village Back in Portchester' (the Vision). After extensive

consultation, the Vision was finalised and set out a future strategy to help regenerate Portchester Village Centre. Following the approval of the Vision in January 2018 an Executive Report was presented giving details of opportunities to change parking arrangements in the Council's car parks to the south of the village centre.

The Vision for Portchester identified potential changes to the car park, which reflected the views of local people to have free and accessible parking that meets the needs of local residents and village centre users, including young families.

The effects of this proposed amendment are: -

- The proposed car park improvements would provide more short stay spaces (maximum stay 3 hours) closer to the pedestrian precinct, with fewer long stay spaces but well orientated to the surrounding community uses. Overall, there will be no net loss of public car parking spaces, whilst facilitating the redevelopment of Assheton Court and maintaining the existing Long Stay East car park for future short-term parking.
- It would introduce parent and child parking bays, conveniently located to the smaller Short Stay car park close to the pedestrian precinct.
- Relocate and increase the number of disabled parking bays, again to the smaller Short Stay car park close to the pedestrian precinct.
- It would remove the Lorry Park, but then provide spaces for smaller Light Goods Vehicles that are to be accommodated in part of the new Short Stay South car park, allowing small goods vehicle to utilise the car park. The existing lorry park would then be converted into car parking spaces to increase the capacity. It is envisaged that Light Goods Vehicles will be allowed to park overnight (24 hours) to deter parking in residential streets.
- The former Lorry Park and the smaller Long Stay car park (south of the Lorry Park) would be combined to provide a single Long Stay car park.

Holly Hill Park Car Park Barnes Lane Sarisbury

Currently parking is allowed for 24 hours, this needs to be amended to 4 hours maximum stay with no return for 4 hours.

Complaints from customers and children's nursery nearby that work vans working in the area are staying in the carpark all day taking up valuable parking bays for other customers visiting the location and country park.

Barnes Close Car Park Sarisbury

Introduce 4 hours with no return for 4 hours restriction.

This car park is located on the other side from Holly Hill Park with 4 disabled bays and 6 normal parking bays, if we enforce Holly Hill with limited wait it will push vehicles into this carpark where there are currently no restrictions.

Broadcut Retail Park

Introduce a 3 hours limited wait with a no return of 5 hours.

This is a new car park for the TRO to cover, complaints have been received from retailers including Pure Gym that lease the units and customers that vehicles are being left in the carpark all day and vehicles are parking in disabled parking bays with no valid Blue Badge.

Cams Alders Car Park

Introduce a 4-hour limited wait with no return for 4 hours

This is by the Rainbow Centre in Cams Alders; it is a new location for the TRO to cover. Complaints have been received from residents in Highfield Avenue that vehicles are being stored in the small section of the carpark, we have evidence of vehicles without Tax frequently being stored there. This will also support the Football Club, the Rainbow Centre and other visitors to the car park.

Passage Lane Warsash

To permit motorcycles if parked in a designated motorcycled bay.

Prior to the recent introduction of charging, there was no provision for motorcycle parking, following a complaint from a member of the public, provision of motorcycle parking has been introduced.

Burridge Village Hall Car Park (Main)

Complaints have been received from users of this car park, that it is used by non-Village Hall users for long periods of time. To reduce the opportunity for this it is proposed to introduce a maximum period of stay of 2 hours with a no return to the car park within 2 hours.

Consultation Results

There were only 3 responses received from residents. Two of the responses related to concern about the proposed changes to the lorry park, in that there would be nowhere for them to park and one was concerned that the car park would be developed for housing.

The final proposed Order

Appendix A contains the proposed Off-Street Parking Places (Amendment 5) Order 2022 for approval. The main provisions are detailed above.

Conclusion

Public consultation results are summarised above and presented for consideration alongside an updated Off-Street Parking Order.

Recommendation/Recommended Option:

It is recommended that the Executive Member for Health and Public Protection:

- (a) considers the representations made; and
- (b) resolves whether to adopt the updated Off-Street Parking Places (Amendment 5) Order found at Appendix A to this report.

Reason:

As detailed within the above.

Cost of Proposals:

The costs of amended signage at the affected car parks and any additional publicity can be met from existing budgets.

Appendices: A: Off Street Parking Places (Amendment 5) Order 2022

Background papers: TRO Consultation Representations

Reference Papers: None.

**THE BOROUGH OF FAREHAM
(OFF-STREET PARKING PLACES) (AMENDMENT 5) ORDER 2022**

Fareham Borough Council in exercise of its powers under Sections 32, 35 and Part IV of Schedule 9 of the Road Traffic Regulation Act 1984 (“the Act”) and of all other enabling powers, with the consent of the Hampshire County Council pursuant to Section 39(3) of the Act and after consultation with the Chief Officer of Police in accordance with Part III of Schedule 9 to the Act, hereby makes the following Order:

CITATION

- 1** This Order shall come into operation on XXXXX and may be cited as The Borough of Fareham (Off-Street Parking Places) (Amendment 5) Order 2022.

INTERPRETATION

- 2** In this Order:
- (i) “Principal Order” shall mean The Borough of Fareham (Off-Street Parking Places) Consolidation Order 2017 (as amended).
 - (ii) Except where otherwise stated, any reference to an Article or Schedule shall be construed as a reference to that Article or Schedule in this Order.
 - (iii) Any reference to an enactment shall be construed as a reference to that enactment as amended by any subsequent enactments.

AMENDMENTS

- 3** Schedule Five of the Principal Order shall be deleted and replaced by the contents of Schedule One to this Order.
- 4** The heading of Schedule Six of the Principal Order shall be deleted and replaced by '24 hour (maximum) car parks (free)'.
- 5** Portchester Precinct Car Park and all its related provisions shall be deleted from Schedule Six of the Principal Order and replaced by the contents of Schedule Two to this Order.
- 6** Holly Hill Car Park, Barnes Lane and all its related provisions shall be deleted from Schedule Six of the Principal Order.
- 7** Hove-to Car Park, Hill Head and all its related provisions shall be deleted from Schedule Six of the Principal Order.

THE COMMON SEAL of
FAREHAM BOROUGH COUNCIL
was hereunto affixed this XX day of
xxxxxxx 2022

in the presence of:

Authorised Signatory

DRAFT

Schedule One

Schedule 5 – Limited wait car parks (free)

1	2	3	4
Name of Parking Place	Classes of Vehicles	Position in which Vehicle may wait	Maximum Period for which Vehicles may wait
Stubbington Lane Car Park, Stubbington	All Vehicles except a) Goods Vehicles exceeding 1525kg unladen weight; b) Passenger Vehicles adapted to carry more than 12 passengers exclusive of the driver and c) Trailers	Wholly within a bay not reserved for any other class of Vehicle or person. Motor Cycles may only wait within a bay marked "Motor Cycles Only"	2 hours
Middle Road Car Park, Park Gate	All Vehicles except a) Goods Vehicles exceeding 1525kg unladen weight; b) Passenger Vehicles adapted to carry more than 12 passengers exclusive of the driver and c) Trailers	Wholly within a bay not reserved for any other class of Vehicle or person Motor Cycles may only wait within a bay marked "Motor Cycles Only"	2 hours, No Return within 4 hours.
The Green Car Park, Stubbington	All Vehicles except a) Goods Vehicles exceeding 1525kg unladen weight; b) Passenger Vehicles adapted to carry more than 12 passengers exclusive of the driver and c) Motor Cycles; and d) Trailers	Wholly within a bay not reserved for any other class of Vehicle or person.	1 hour, No Return within 3 hours.

Car Park Rear of Standen-House, Stubbington	All Vehicles except a) Goods Vehicles exceeding 1525kg unladen weight; b) Passenger Vehicles adapted to carry more than 12 passengers exclusive of the driver and c) Trailers	Wholly within a bay not reserved for any other class of Vehicle or person. Motor Cycles may only wait within a bay marked "Motor Cycles Only"	1 hour No Return within 3 hours.
Leisure Centre Park Lane, Fareham	All Vehicles except a) Goods Vehicles exceeding 1525kg unladen weight; and b) Trailers	Wholly within a bay not reserved for any other class of Vehicle or person. Motor Cycles may only wait within a bay marked "Motor Cycles Only" and coaches may only wait in "Coaches Only Zone"	3 hours every day including Bank Holidays and Sundays. Coaches only Zone to apply 9am to 6pm
Broadcut, Wallington	All Vehicles except a) Goods Vehicles exceeding 1525kg unladen weight; b) Passenger Vehicles adapted to carry more than 12 passengers exclusive of the driver; and c) Trailers	Wholly within a bay not reserved for any other class of Vehicle or person. Motor Cycles may only wait within a bay marked "Motor Cycles only"	3 hours Monday to Friday No return within 5 hours.
Leigh Road Car Park	All Vehicles except a) Goods Vehicles exceeding 1525kg unladen weight; b) Passenger Vehicles adapted to carry more than 12 passengers exclusive of the driver; c) Motor Cycles; and d) Trailers	Wholly within a bay not reserved for any other class of Vehicle or person	4 hours

Highlands Road, Shopping Area Car Park	All Vehicles except a) Goods Vehicles exceeding 1525kg unladen weight; b) Passenger Vehicles adapted to carry more than 12 passengers exclusive of the driver; c) Motor Cycles; and d) Trailers	In a position not causing obstruction to any access exit or internal circulating route for Vehicles	Southeast side of service road - 2 hours 8am-7pm Monday to Saturday Northwest side of service road - 4 hours 8am-7pm Monday to Saturday
Barry's Meadow Car Park	All Vehicles except a) Goods Vehicles exceeding 1525kg unladen weight; b) Passenger Vehicles adapted to carry more than 12 passengers exclusive of the driver; and c) Trailers	Wholly within a bay not reserved for any other class of Vehicle or person. Motor Cycles may only wait within a bay marked "Motor Cycles Only".	3 Hours
Bishopsfield Road Car Park	All Vehicles except a) Goods Vehicles exceeding 1525kg unladen weight; b) Passenger Vehicles adapted to carry more than eight (8) passengers exclusive of the driver; and c) Trailers	Wholly within a bay not reserved for any other class of Vehicle or person. Motor Cycles may only wait within a bay marked "Motor Cycles Only".	3 hours between 0800 and 1800 hours on any day and up to 14 hours outside of those hours
Fareham North West Community Centre Car Park	All Vehicles except a) Goods Vehicles exceeding 1525kg unladen weight; b) Passenger Vehicles adapted to carry more than 12 passengers exclusive of the driver; c) Trailers; and d) Motor Cycles	Wholly within a bay not reserved for any other class of Vehicle or person	20 minutes between 0800 and 1800 hours with no return within 2 hours on Mondays to Fridays inclusive No maximum waiting period on Saturdays and Sundays and recognised Bank Holidays

Burridge Village Hall Car Park (Main)	All Vehicles except a) Goods Vehicles exceeding 1525kg unladen weight; b) Passenger Vehicles adapted to carry more than 12 passengers exclusive of the driver; c) Motor Cycles; and d) Trailers	Wholly within a bay not reserved for any other class of Vehicle or person	2 hours, No Return within 2 hours. Official Permit Holders may wait for a period not exceeding 24 hours
Warsash Road Car Park Warsash	All Vehicles except a) Goods Vehicles exceeding 1525kg unladen weight; b) Passenger Vehicles adapted to carry more than 12 passengers exclusive of the driver and c) Trailers.	Wholly within a bay not reserved for any other class of Vehicle or person. Motor Cycles may only wait within a bay marked "Motor Cycles Only".	4 Hours No return within 4 hours
Holly Hill Car Park, Barnes Lane	All Vehicles except a) Goods Vehicles exceeding 1525kg unladen weight; b) Motor Cycles and c) Passenger Vehicles adapted to carry more than 12 passengers exclusive of the driver; and d) Trailers	Wholly within a bay not reserved for any other class of Vehicle or person.	4 Hours No return within 4 hours
Barnes Close, Sarisbury	All Vehicles except a) Goods Vehicles exceeding 1525kg unladen weight; b) Motor Cycles and c) Passenger Vehicles adapted to carry more than 12 passengers exclusive of the driver; and d) Trailers	Wholly within a bay not reserved for any other class of Vehicle or person.	4 Hours No return within 4 hours

Broadcut Retail Park, Wallington	All Vehicles except a) Goods Vehicles exceeding 1525kg unladen weight; b) Motor Cycles; c) Passenger Vehicles adapted to carry more than 12 passengers exclusive of the driver and d) Trailers.	Wholly within a bay not reserved for any other class of Vehicle or person.	3 Hours No return within 5 hours
Cams Alders Car Park	All Vehicles except a) Goods Vehicles exceeding 1525kg unladen weight; b) Motor Cycles; c) Passenger Vehicles adapted to carry more than 12 passengers exclusive of the driver; and d) Trailers.	Wholly within a bay not reserved for any other class of Vehicle or person.	4 Hours No return within 4 hours

Schedule Two

Portchester Precinct Car Park	All Vehicles	<p>Wholly within a bay not reserved for any other class of Vehicle or person.</p> <p>Motor Cycles may only wait within a bay marked "Motor Cycles Only".</p>	<p>24 hours every day including Sundays and recognised Public Holidays except for the parking areas shown as "3 Hour Parking" on the plan attached hereto, which shall be 3 hours every day including Sundays and recognised Public Holidays</p>
-------------------------------	--------------	--	--



FAREHAM BOROUGH COUNCIL

PO BOX 82 CIVIC OFFICES CIVIC WAY FAREHAM PO16 7TT

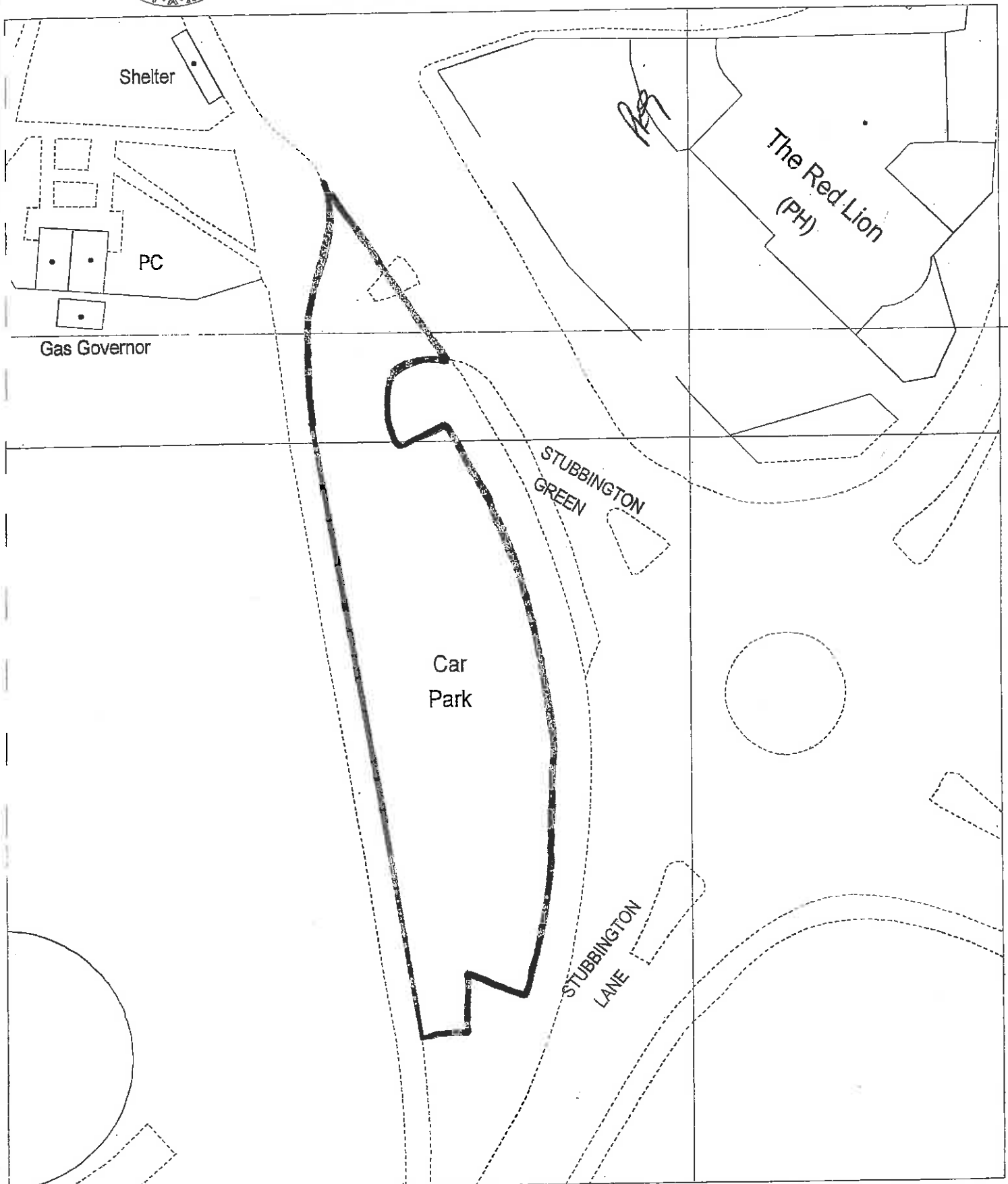

Stubbington Lane Car Park,
Stubbington.

Dwg. No.	E/1608	APPENDIX A
Date	26th February 2001	Scale 1:500

Reproduced from the Ordnance Survey Landline Data with the permission of Her Majesty's Stationery Office. © Crown Copyright. Unauthorised reproduction breaks Crown copyright and may lead to prosecution or civil proceedings.





FAREHAM BOROUGH COUNCIL

PO BOX 82 CIVIC OFFICES CIVIC WAY FAREHAM PO16 7TT

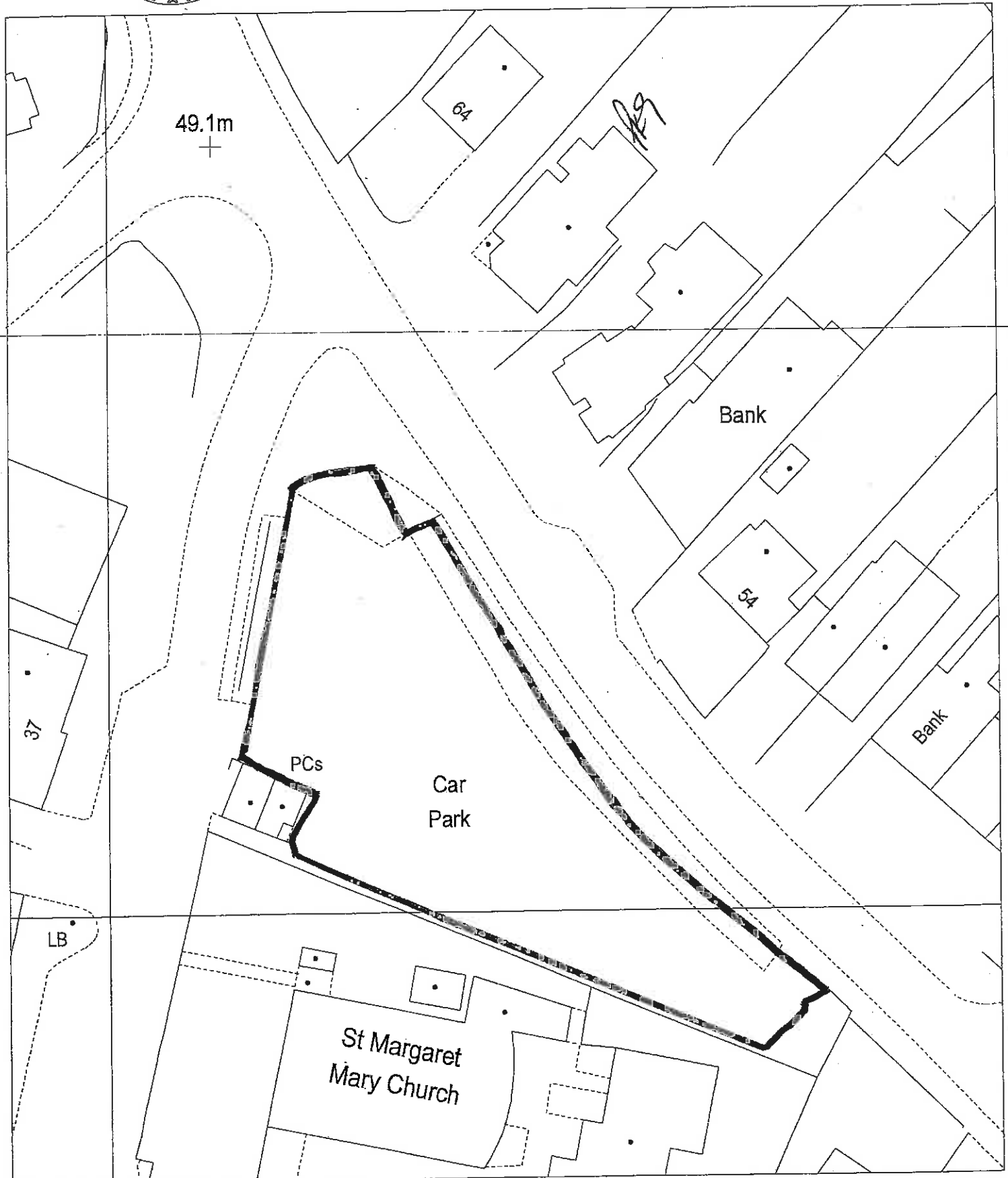

Middle Road Car Park, Park Gate

Page 16

Dwg. No. E/1615	APPENDIX A
Date 15th February 2001	Scale 1:500

Reproduced from the Ordnance Survey Landline Data with the permission of Her Majesty's Stationery Office. © Crown Copyright. Unauthorised reproduction breaks Crown copyright and may lead to prosecution or civil proceedings. Fareham Borough Council LA 077978





FAREHAM BOROUGH COUNCIL

PO BOX 82 CIVIC OFFICES CIVIC WAY FAREHAM PO16 7TT

Sub Sta

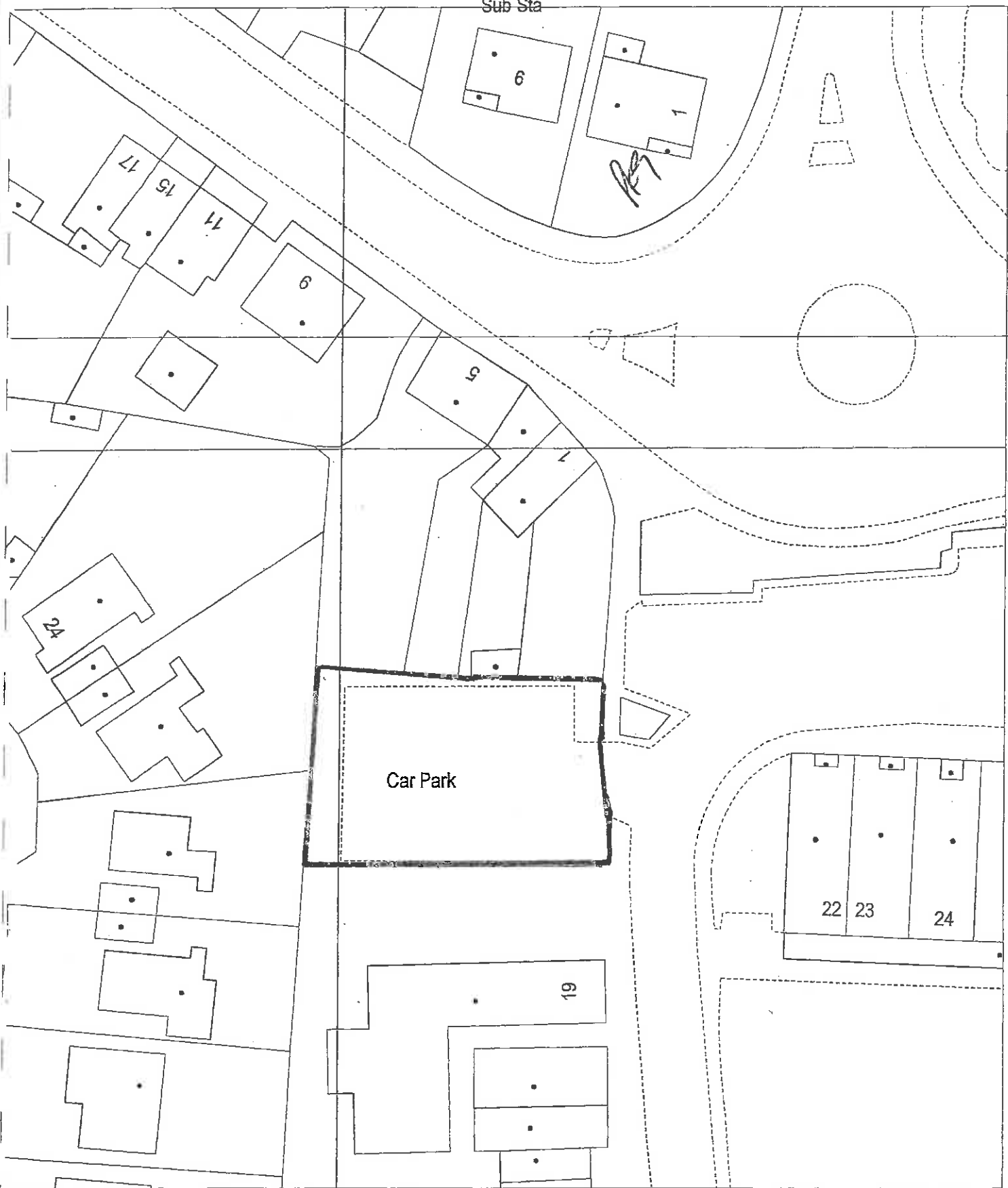

The Green Car Park, Stubbington

Page 17

Dwg. No. **E/1612**

APPENDIX A

Date 13th February 2001

Scale 1:500

Reproduced from the Ordnance Survey Landline Data with the permission of Her Majesty's Stationery Office. © Crown Copyright
Unauthorized reproduction breaks Crown copyright
and may lead to prosecution or civil proceedings
Fareham Borough Council LA 07/2006





FAREHAM BOROUGH COUNCIL

PO BOX 82. CIVIC OFFICES CIVIC WAY FAREHAM PO16 7TT

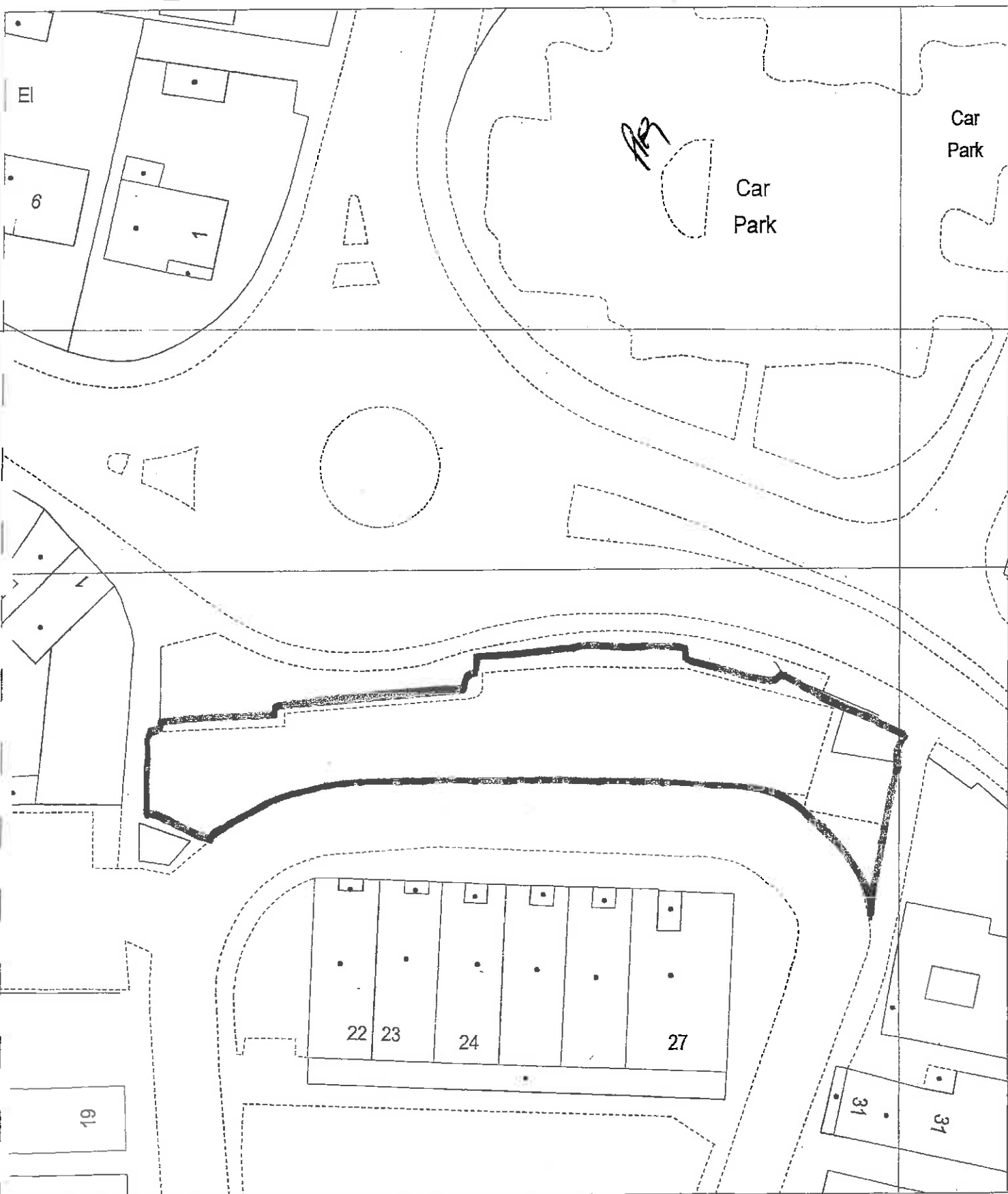

Car Park Rear of Standen-House,
Stubbington

Dwg. No. E/1613	APPENDIX A
Date 26th February 2001	Scale 1:500
<small>Reproduced from the Ordnance Survey Landline Data with the permission of Her Majesty's Stationery Office. © Crown Copyright. Unauthorised reproduction breaks Crown copyright and may lead to prosecution or civil proceedings. Ordnance Survey Licence 1.0 1773072</small>	





FAREHAM BOROUGH COUNCIL

PO BOX 82 CIVIC OFFICES CIVIC WAY FAREHAM PO16 7TT

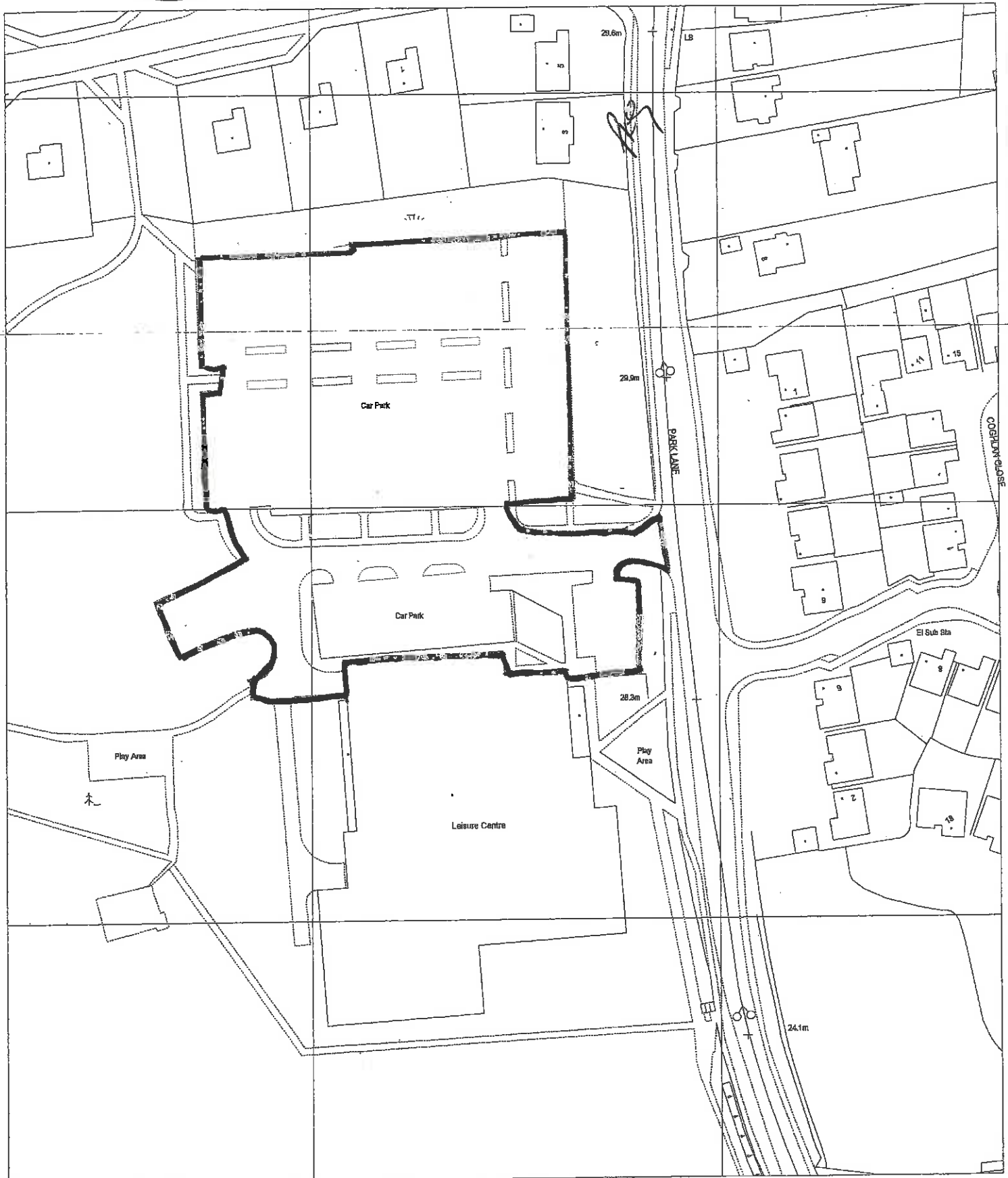

Leisure Centre Car Park, Fareham
Page 19

Dwg. No. **E/1621**

APPENDIX A

Date 14th February 2001

Scale 1:1250

Reproduced from the Ordnance Survey Landmark Data with the permission of Her Majesty's Stationery Office. © Crown Copyright. Unauthorised reproduction breaks Crown copyright and may lead to prosecution or civil proceedings. Fareham Borough Council 1 & 1979/27





FAREHAM BOROUGH COUNCIL

PO BOX 82 CIVIC OFFICES CIVIC WAY FAREHAM PO16 7TT

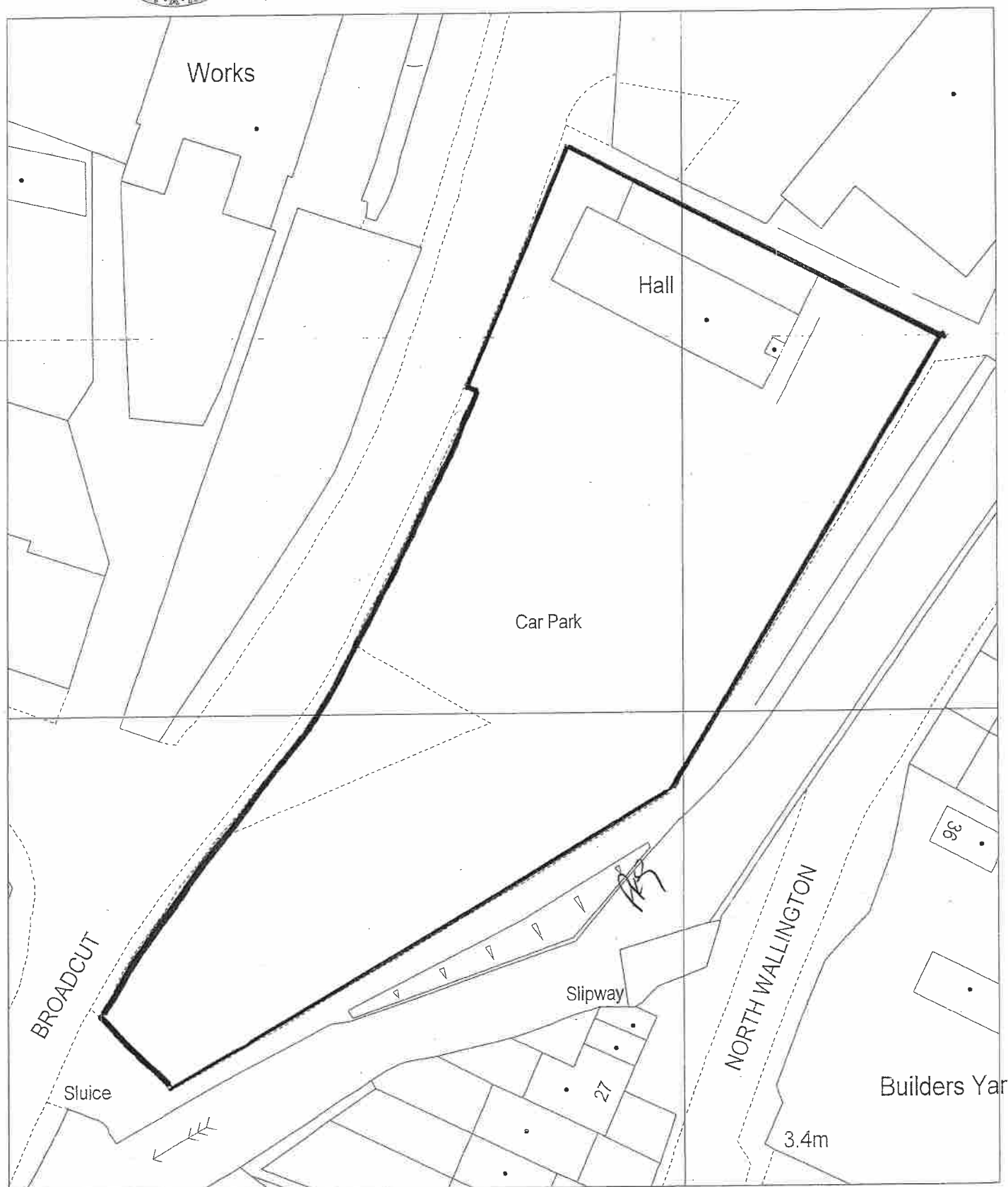

Broadcut, Wallington

Dwg. No. **E/1636**

APPENDIX A

Date 23rd January 2001

Scale-

Reproduced from the Ordnance Survey Landuse Data with the permission of Her Majesty's Stationery Office. © Crown Copyright. Unauthorized reproduction breaks Crown copyright and may lead to prosecution or civil proceedings. Fareham Borough Council: LA 077976



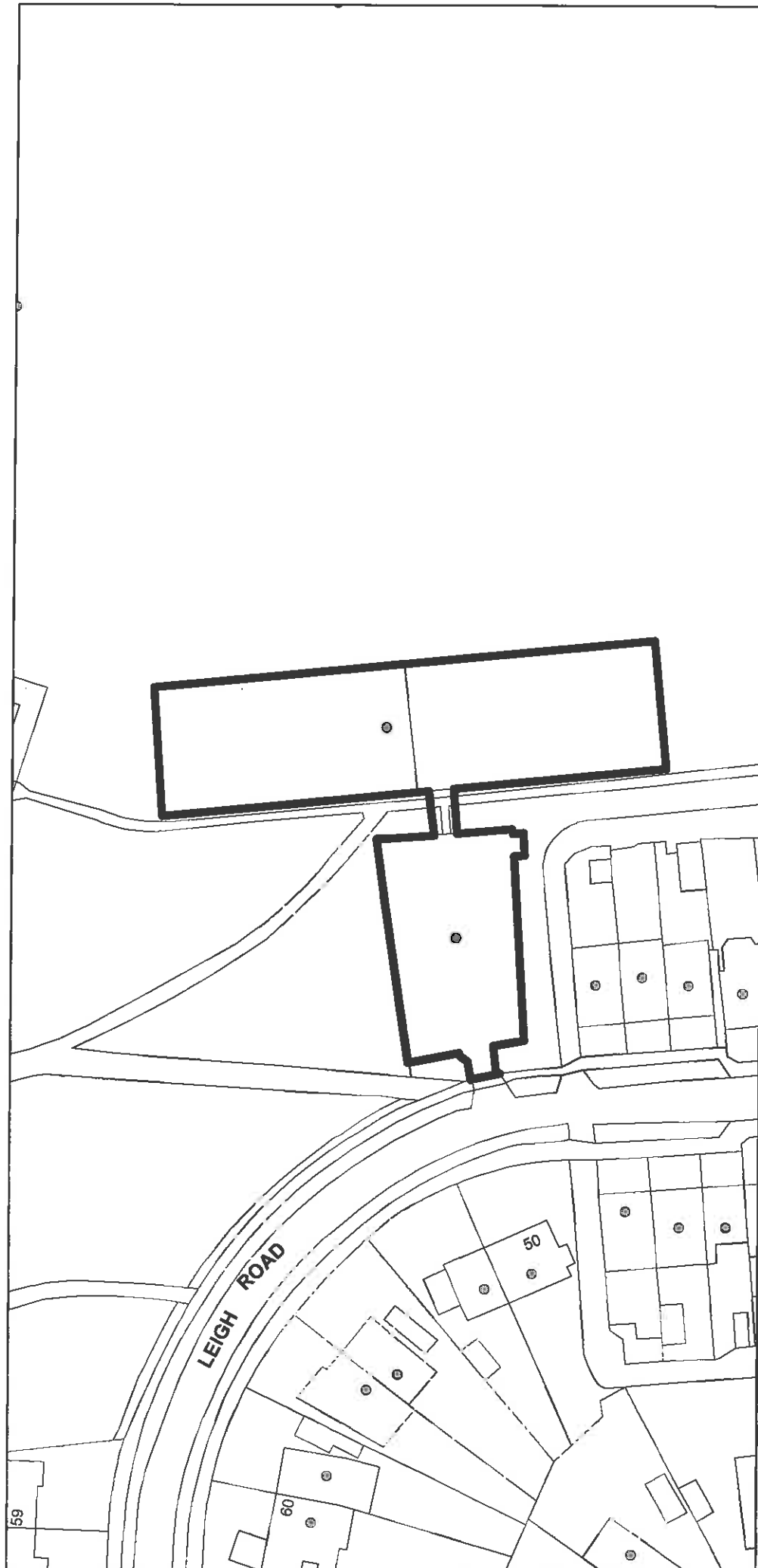

Drawing No. E/1595

APPENDIX A

Date: 16th June 2017

Scale: 1:500

Leigh Road Car Park

This map is reproduced from Ordnance Survey material with the permission of Ordnance Survey on behalf of the Controller of Her Majesty's Stationary Office © Crown Copyright. Unauthorised reproduction infringes Crown Copyright and may lead to prosecution or civil proceedings. Licence 100019110. 2013



FAREHAM BOROUGH COUNCIL

PO BOX 82 CIVIC OFFICES CIVIC WAY FAREHAM PO16 7TT

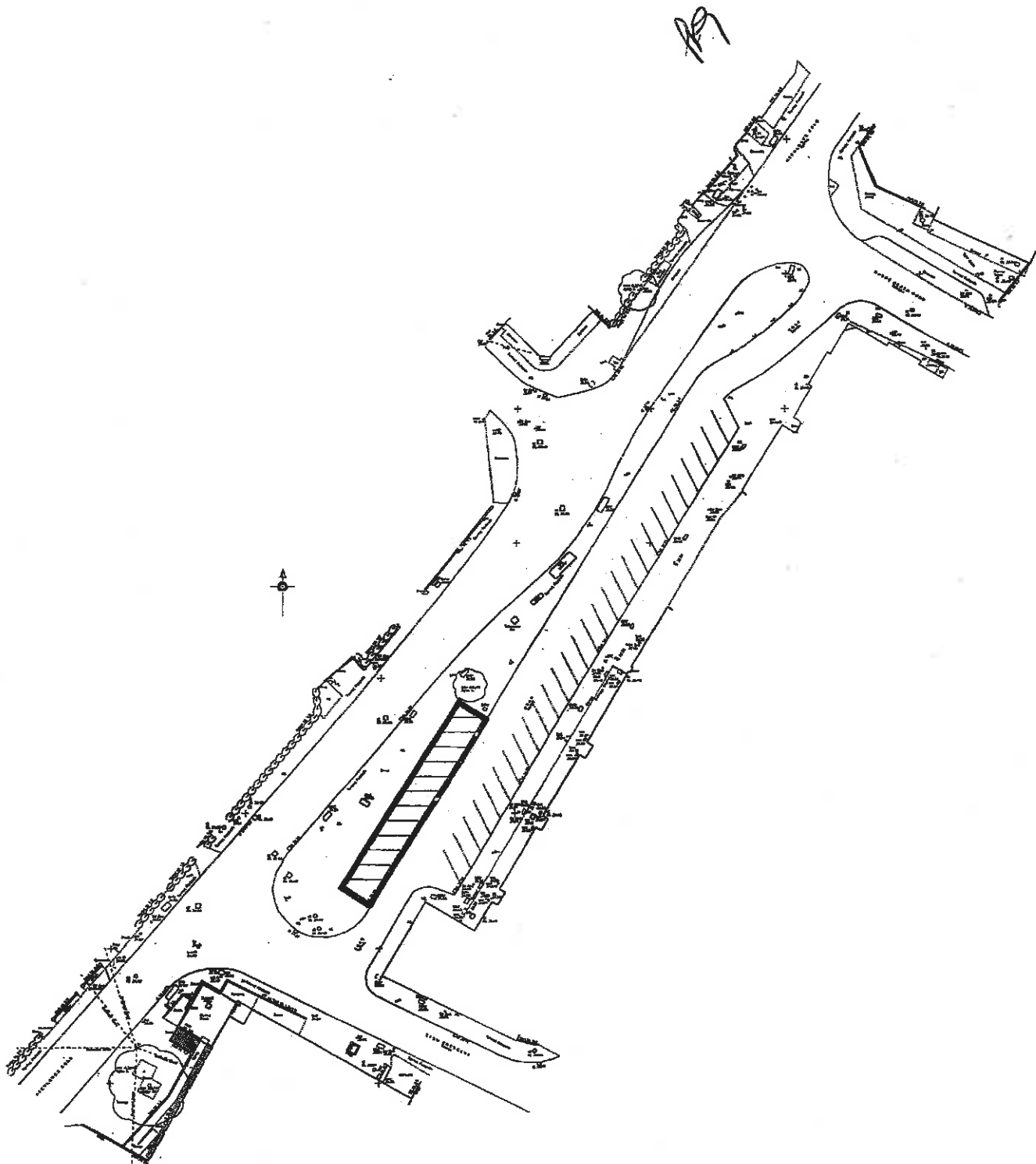

Highlands Road, Shopping Area Car Park

Page 22

Dwg. No.	E/1616	APPENDIX A
Date	13th February 2001	Scale 1:500
<small>Reproduced from the Ordnance Survey Landline Data with the permission of Her Majesty's Stationary Office. © Crown Copyright. Unauthorised reproduction breaks Crown copyright and may lead to prosecution or civil proceedings. Fareham Borough Council LA 077978</small>		





FAREHAM BOROUGH COUNCIL

PO BOX 82 CIVIC OFFICES CIVIC WAY FAREHAM PO16 7TT

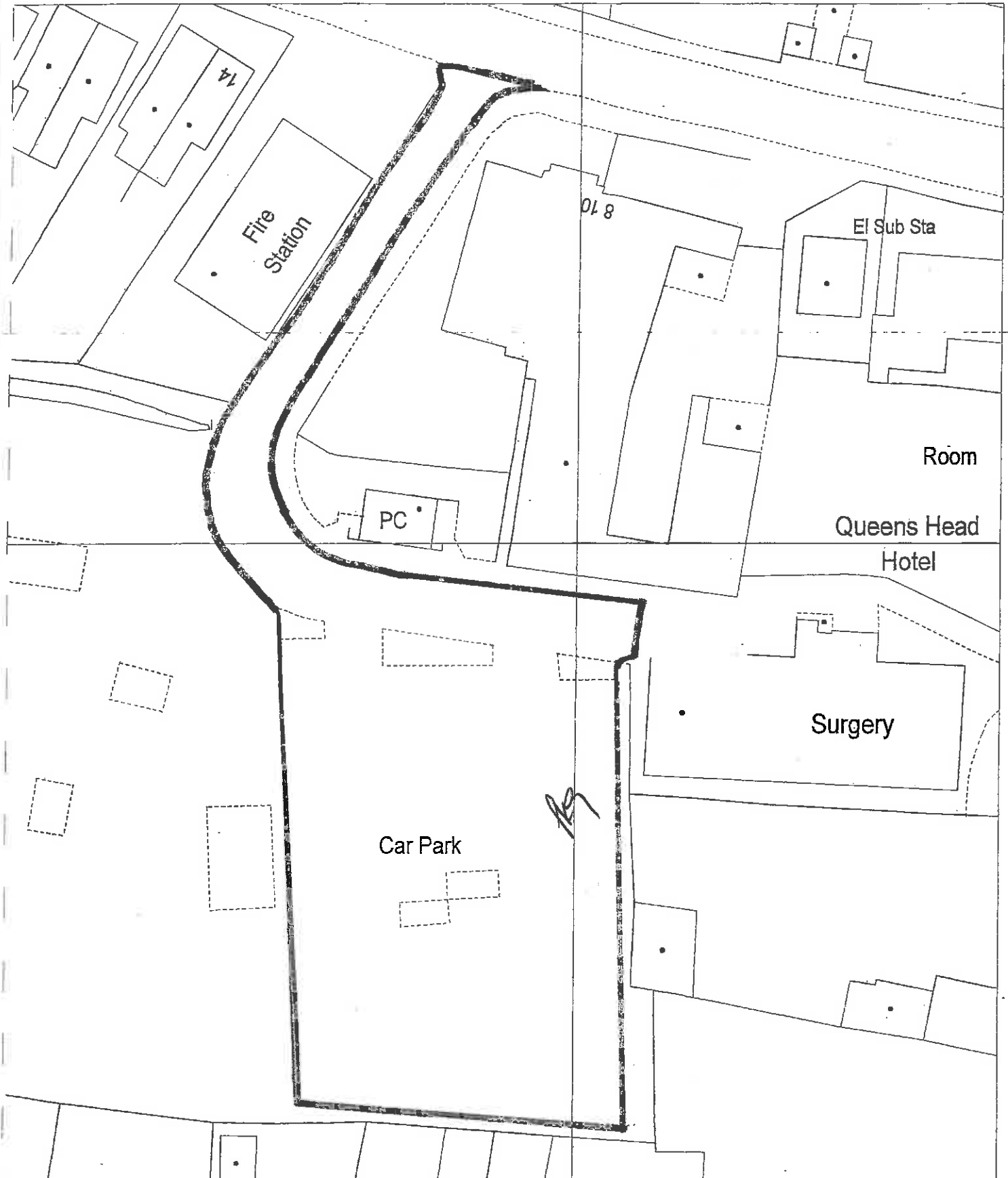

Barry's Meadow Car Park

Dwg. No. **E/1620**

APPENDIX A

Date 23rd January 2001

Scale 1:500

Reproduced from the Ordnance Survey Landline Data with the permission of Her Majesty's Stationery Office. © Crown Copyright. Unauthorized reproduction breaks Crown copyright and may lead to prosecution or civil proceedings. Fareham Borough Council LA 077976





FAREHAM BOROUGH COUNCIL

PO BOX 82 CIVIC OFFICES CIVIC WAY FAREHAM PO16 7TY

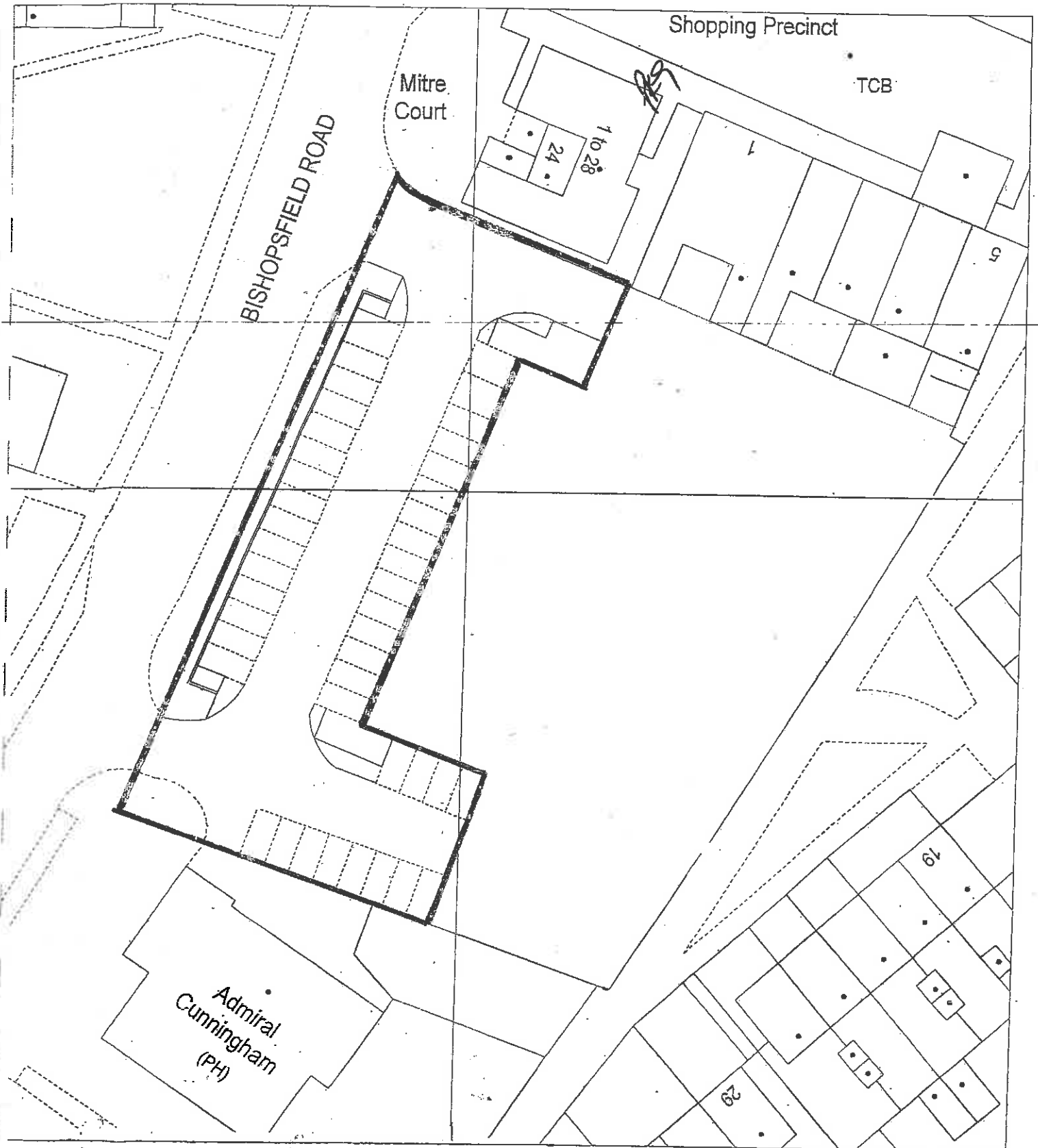

Bishopsfield Road Car Park

Rev	Amendment	By	Chkd.	Date	Appd.	Drawn By	Date	Checked By	Date	Approved By	Date
						Harun Miah	06/03/03	Sandra Hill	06/03/03		
						Drawing No. ET/0074/1/A					
						Page 24 Scale					
<small>Reproduced from the Ordnance Survey Landline Data with the permission of Her Majesty's Stationary Office. © Crown Copyright.</small>											







FAREHAM BOROUGH COUNCIL

PO BOX 82 CIVIC OFFICES CIVIC WAY FAREHAM PO16 7TY

Fareham Park
Farm Cottages

2

Community Centre

Disabled parking bay

Proposed area of order
within dashed line

Henry Cort Drive

39.0m

School car park

Fareham North West Community Centre car park Order

Rev.	Amendment	By	Chkd.	Date	Appd.	Drawn By	Date	Checked By	Date	Approved By	Date

Drawing No. **0002**

Scale **1:500**

Reproduced from the Ordnance Survey Landline Database Inc. permission of Her Majesty's Stationery Office. © Crown Copyright. Unauthorised reproduction is a criminal offence and may lead to prosecution or civil proceedings. Fareham Borough Council LA 077016

Rev. **A**

FAREHAM

BOROUGH COUNCIL

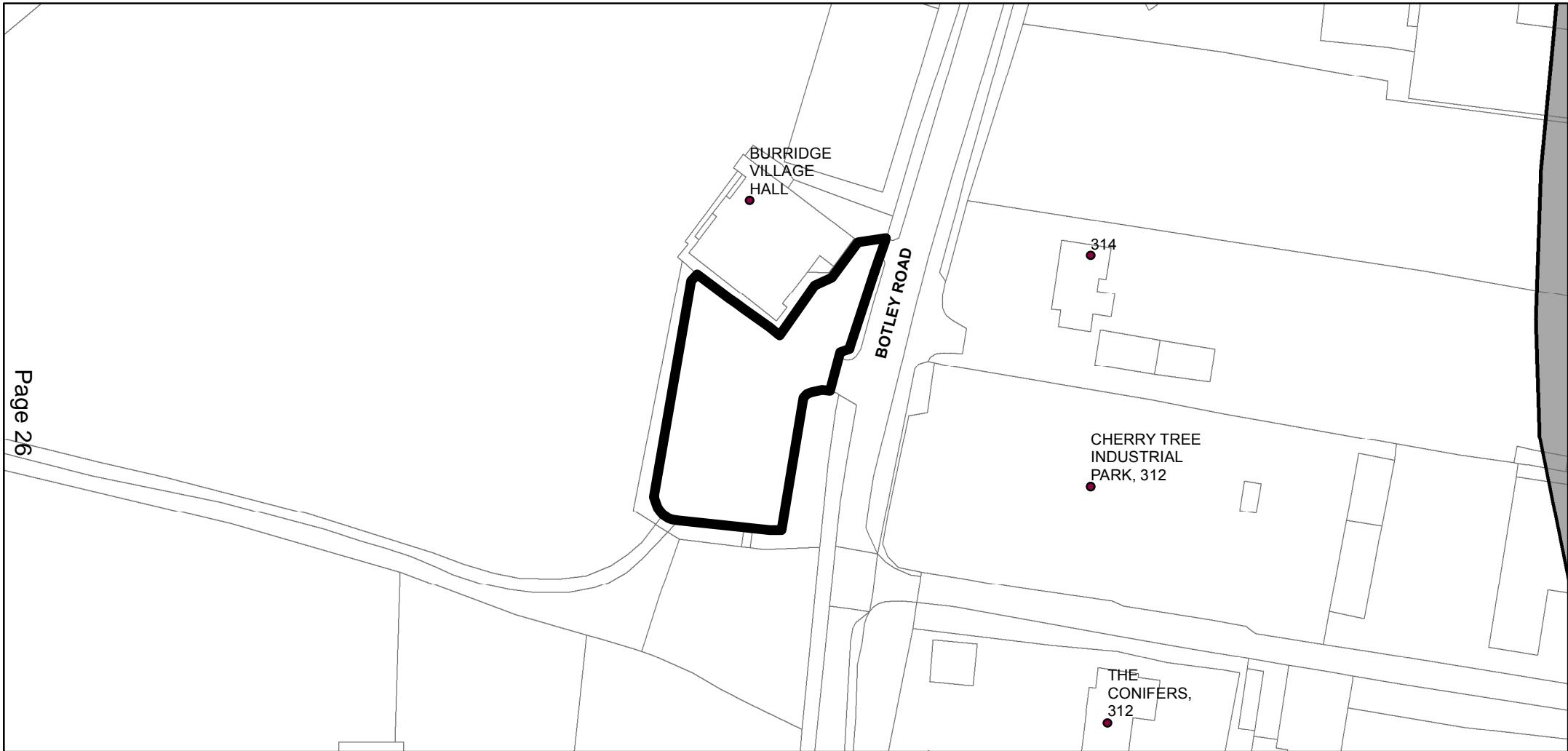

Page 26

Burridge Village Hall Car Park

Drawing No.

APPENDIX A

Date: 24th May 2018

Scale: 1:1,000

© Crown copyright and database rights 2018 Ordnance Survey 100019110. You are permitted to use this data solely to enable you to respond to, or interact with, the organisation that provided you with the data. You are not permitted to copy, sub-licence, distribute or sell any of this data to third parties in any form.



FAREHAM BOROUGH COUNCIL

PO BOX 82 CIVIC OFFICES CIVIC WAY FAREHAM PO16 7TT

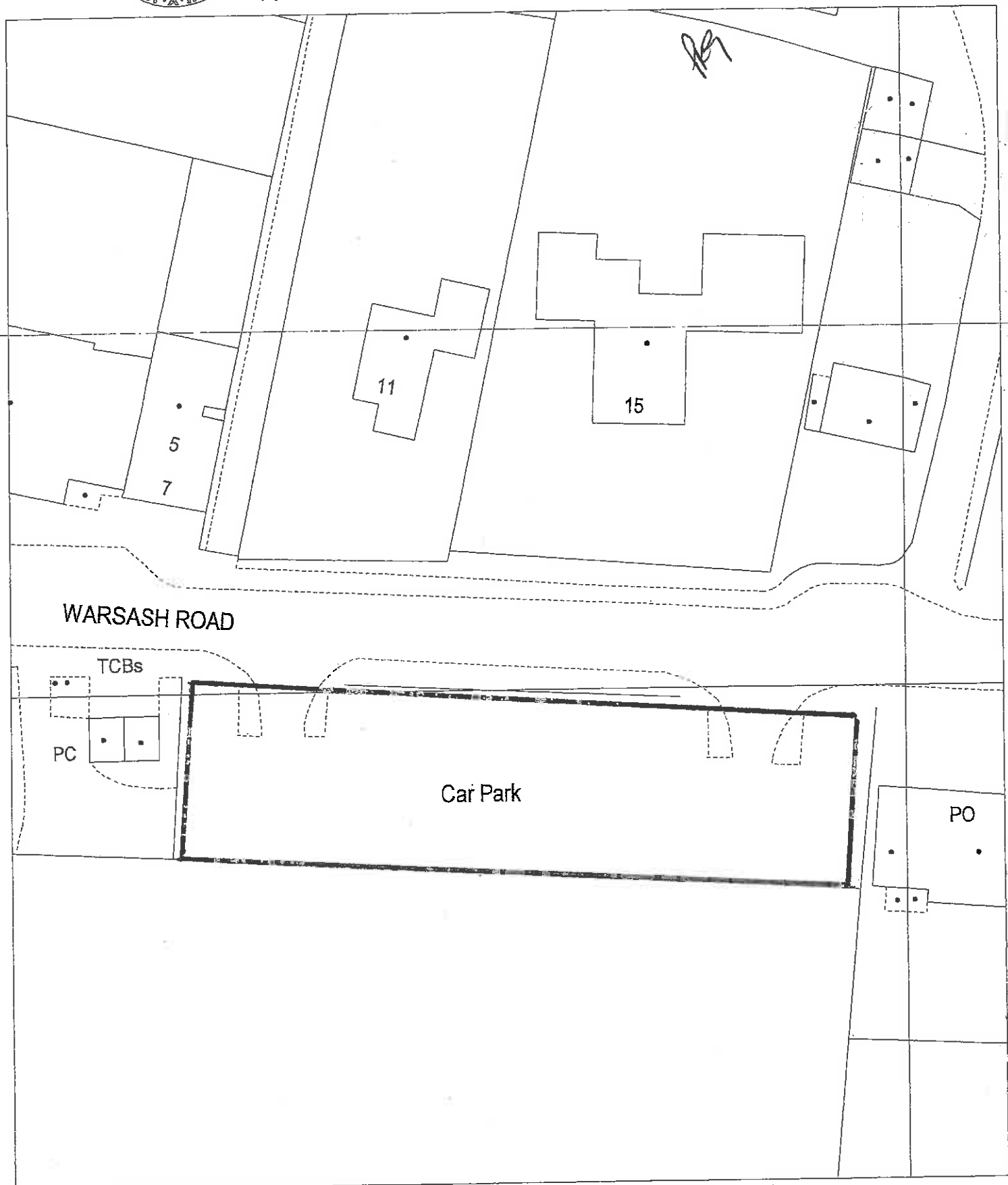

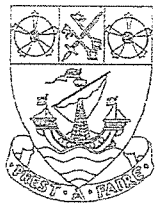

FAREHAM BOROUGH COUNCIL

PO BOX 82 CIVIC OFFICES CIVIC WAY FAREHAM PO16 7TT

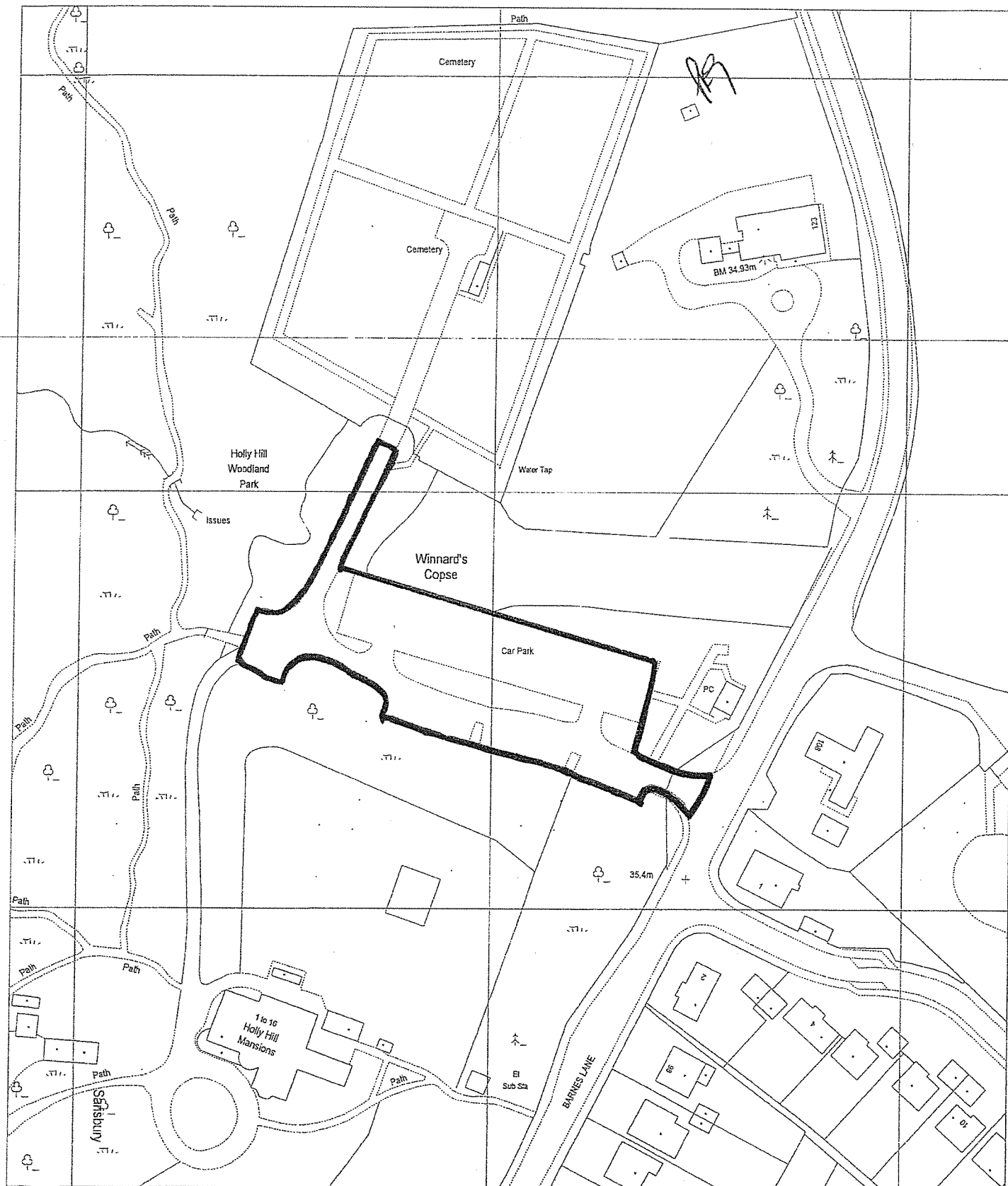

Holly Hill Car Park, Barnes Lane

Dwg. No. **E/1625**

APPENDIX A

Date 14th February 2001

Scale 1:1250

Reproduced from the Ordnance Survey Landline Data with the permission of Her Majesty's Stationary Office. © Crown Copyright
Unauthorised reproduction breaks Crown copyright
and may lead to prosecution or civil proceedings
Fareham Borough Council LA 077976





Barnes Close Car Park
Scale 1:1250

© Crown copyright and database rights 2019 Ordnance Survey 100019110. You are permitted to use this data solely to enable you to respond to, or interact with, the organisation that provided you with the data. You are not permitted to copy, sub-licence, distribute or sell any of this data to third parties in any form.

FAREHAM
BOROUGH COUNCIL

Broadcut Retail Park Car Park

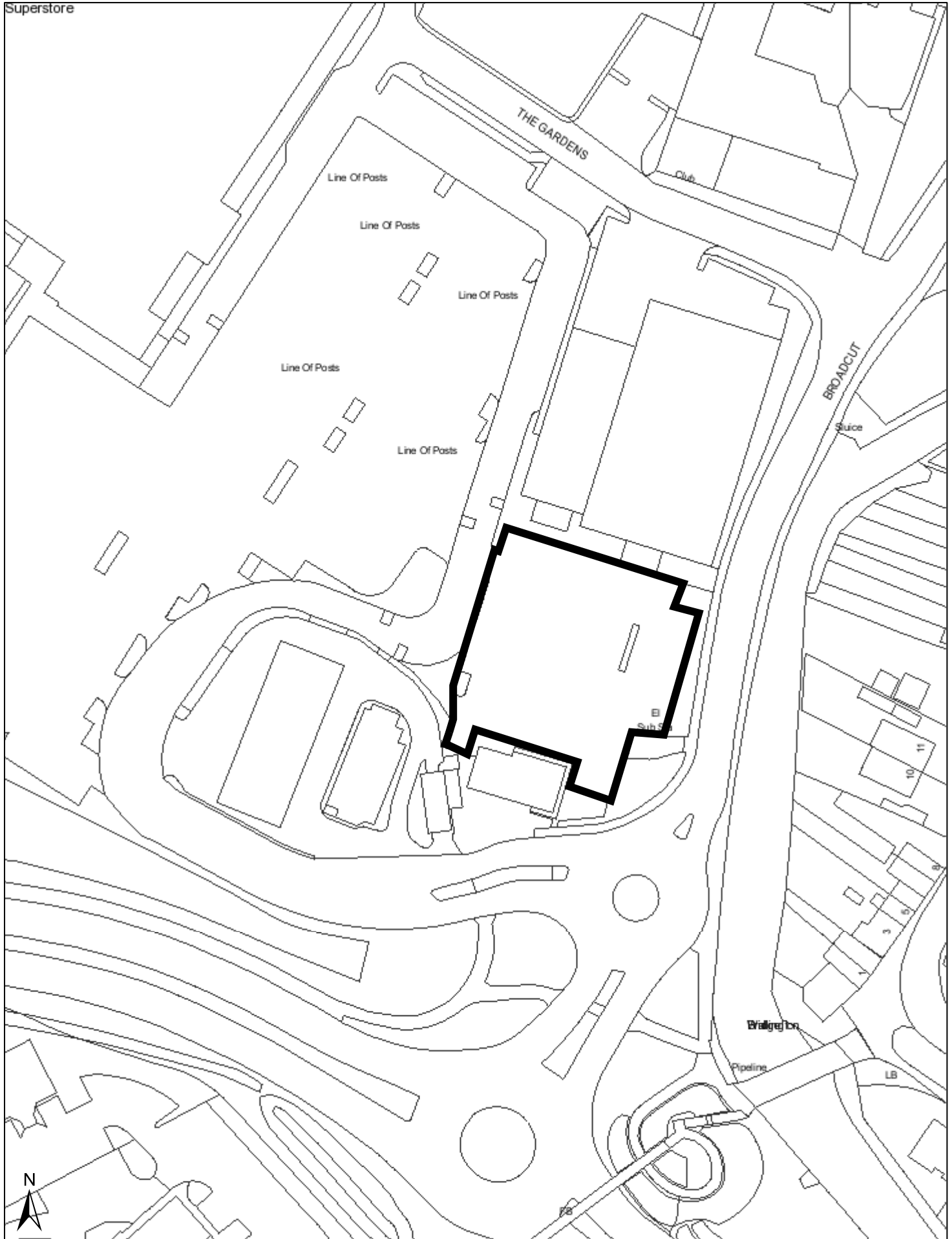

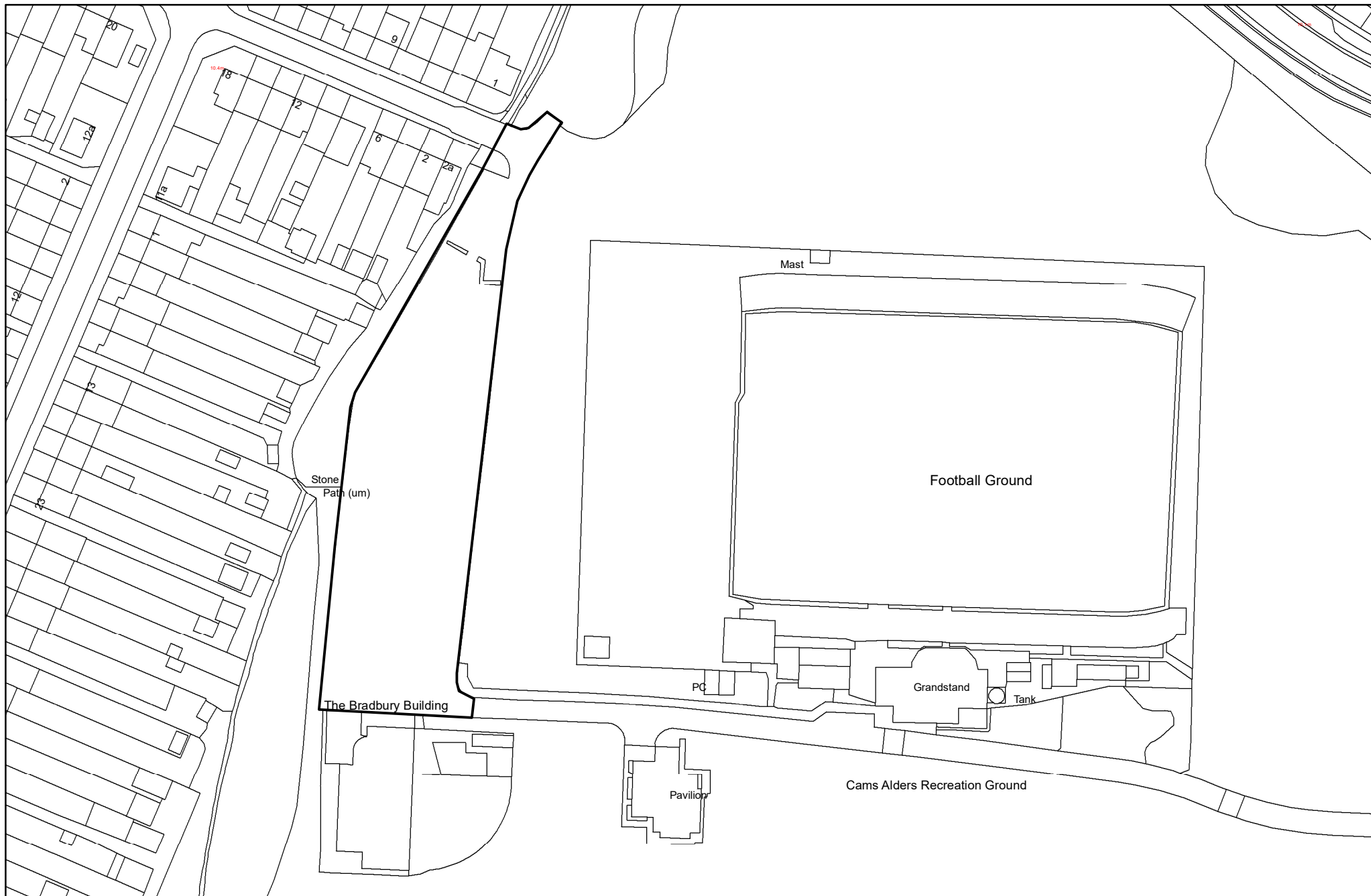

Cams Alders Car park
Scale 1:1250

© Crown copyright and database rights 2019 Ordnance Survey 100019110. You are permitted to use this data solely to enable you to respond to, or interact with, the organisation that provided you with the data. You are not permitted to copy, sub-licence, distribute or sell any of this data to third parties in any form.

FAREHAM
BOROUGH COUNCIL

Portchester Precinct Car Park

